

CUSTOMER: Wolfspeed, a Cree Company		SPECIFICATION		TYPE PFC4529/CE
SYMBOL	DATE	REQUEST NO.	REVISIONS	CLIENT

NOTE:	SPEC. NO. PS20-170 1/3
-------	------------------------------

SPECIFICATION

TYPE
PFC4529/CE

1. Appearance

1-1. Dimension (mm)

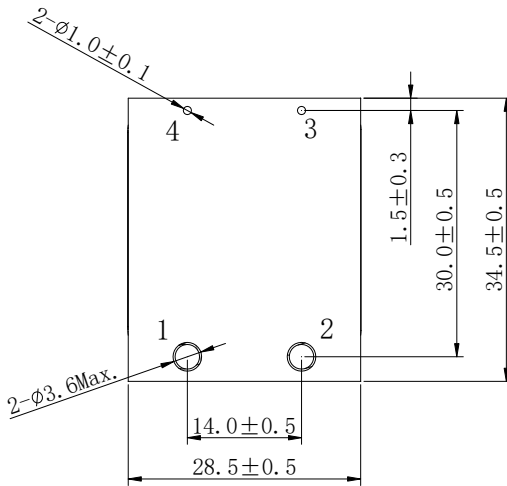
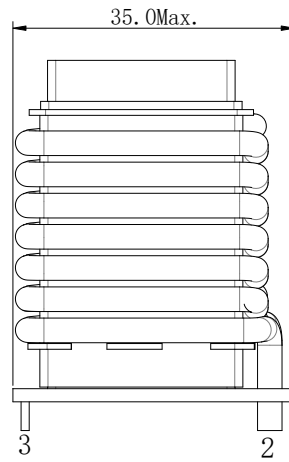
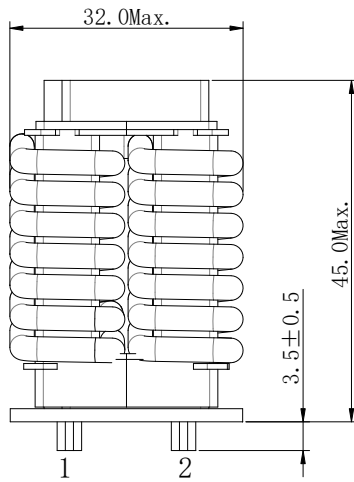

1-2. STAMP

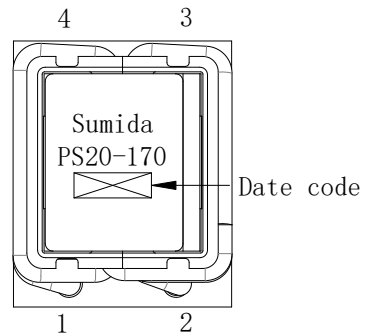

2. Coil specification

2-1. Connection

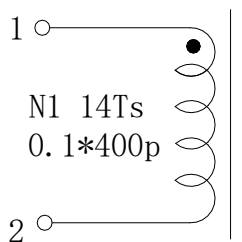

“•” indicates the winding polarity.

RoHS
Compliance
Cd: Max. 0.01wt%
others: Max. 0.1wt%

CHK.	CHK.	DRG.	Sumida P/N	PS20-170	
			Customer P/N	TBD	Spec. No. PS20-170 2/3
			First Issue	Sep., 5 th , 2020	

SPECIFICATION

TYPE PFC4529/CE

2-2. electrical characteristics (At 25°C unless otherwise specified)

Item	Pin	Specification	Measuring conditions
Inductance	(1-2)	9uH+ ±10% (9.23uH Typ.)	100kHz, 1V
DCR	(1-2)	10mΩ Max. (5.85mΩ Typ.)	
Hi-pot	(1, 2-Core)	AC 1000Vrms	50Hz, 1.0mA, 60Sec.

3. Materials list:

No.	Part No.	Material	UL file No.	Manufacture factory
1	CORE	DMR95 TPW33	N/A N/A	DMEGC TDG
2	WIRE 2	Litz Wire, φ0.1mm, 400 strands Litz Wire must be NEMA MW 79-C or MW 80-C	E211989	GREAT LEOFロン INDUSTRIAL CO LTD
3	BOBBIN	T375J	E59481	CHANG CHUN PLASTICS CO LTD
4	PCB	FR4	E123995	VARIOUS
5	TAPE	PF301	E165111	JINGJIANG YAHUA PRESSURE SENSITIVE GLUE CO LTD
6	MARGIN TAPE	WF-2901	E165111	JINGJIANG YAHUA PRESSURE SENSITIVE GLUE CO LTD
7	EPOXY	EPOXY ADHESIVE	N/A	Nagase ChemteX Corporation
8	EPOXY	EPOXY ADHESIVE	N/A	HENKEL LOCTITE CO., LTD

4. Note

- * Operation temperature range: -40°C ~ +125°C. (Including the temperature rise of coil)
- * Storage temperature range: -40°C ~ +125°C.

Note:	Spec. No. PS20-170 3/3
-------	------------------------------